

BYT09

Magnetic guide tube for cartridge valve

- Push type, four section argon arc welding, external hexagon thread connection

BYT09-16-01

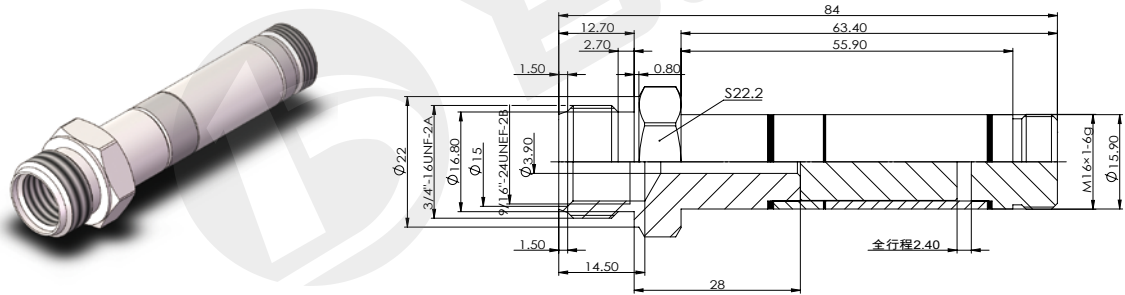

technical parameter					
Working oil pressure	MPa	≤ 21	Hexagon size	mm	22.2

BYT09-16-01M

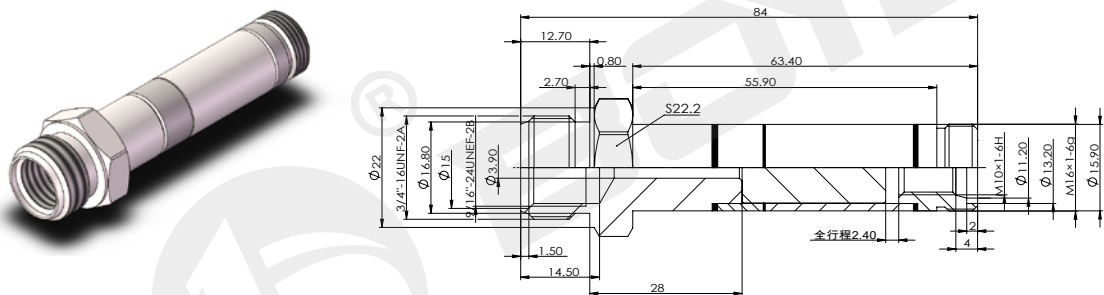

technical parameter					
Working oil pressure	MPa	≤ 21	Hexagon size	mm	—