

**DC 12V**  
**DC 24V**

Other can be customized

- Suitable for electromagnetic multi-way valves
- Comes with return spring

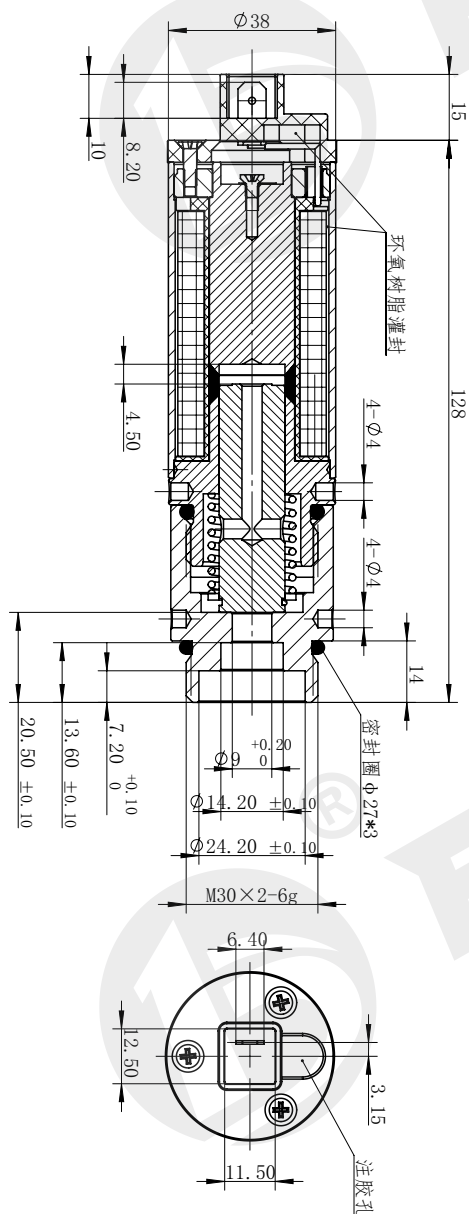

technical parameter		
Ambient temperature	℃	-25~50
Voltage fluctuation range	%	85 ~ 110
Rated power	W	56.3
Rated stroke	mm	4.5
Full stroke	mm	≥ 4.5
Working oil pressure	Mpa	≤ 30
Degree of protection		IP54
Operating frequency	T/h	12000
Power on duration	%	100
Insulation class		H(180)
Electrical connection mode		DT04-2P

### F-S characteristic curve

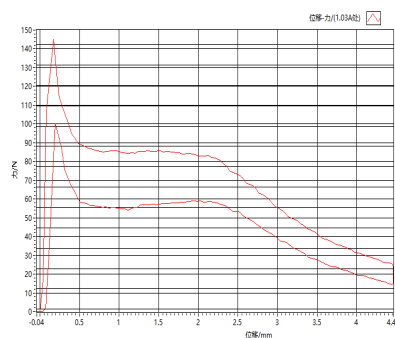

The sample data comes from the laboratory environment and is only for reference. If your company needs the latest data or has special needs, please contact Boye hydraulic engineer.